



Dongguan Taotao Electronics Co., Ltd.
ttencoder.com

14mm Manual Incremental Absolute Rotary Shaft Encoder Household Appliances

Our Product Introduction

for more products please visit us on ttencoder.com

Basic Information

- Place of Origin: CHINA
- Brand Name: TAOWAVES
- Certification: ISO9001,IATF16949
- Model Number: ES14B00V01
- Minimum Order Quantity: 2000pcs
- Price: 0.25~0.35USD
- Packaging Details: Blister tray inside, carton outside
- Delivery Time: 7-15working days
- Payment Terms: T/T
- Supply Ability: 5,000,000pcs/Month



Product Specification

- Shaft Type: Plastic Shaft
- Working Principle: Incremental
- Size: 14mm
- Operating Life: 30000cycles
- Detent: 11/12
- Signal Output: Absolute
- Highlight: **absolute rotary shaft encoder,
absolute rotary encoder,
absolute encoder rotary**



More Images



Product Description

Household Appliances Used 14mm Manual Absolute Rotary Incremental Shaft Encoder

Product Description

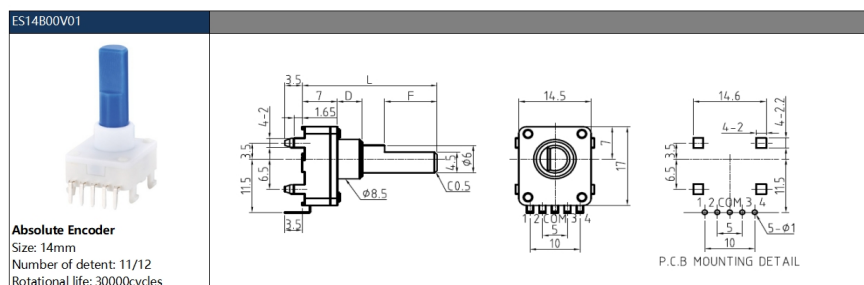

ES14 Product Specifications

1.Electrical Characteristics	
Rated voltage:	DC 5V
Rated current :	1mA (Resistance loading)
Max. operating current:	2.5mA (Resistance loading)
Resolution:	8/12pulses/360°
Insulation resistance:	10MΩ Min at DC 50V
Dielectric strength:	1 minute at AC 50V
Channel:	8 Channel
2.Mechanical Characteristics	
Total ratational angle:	360°(Endless)
Number and position of detent:	8detents Step angle:45°±5°
Detent torque:	5 35mN.m.(50 350gf.cm)
Shaft wobble:	0.8*L/30mm p-p MAX
Push-Pull Strength of shaft	5KG
3.Endurance Characteristics	
Rotational life:	30,000cycles
Operating temperature range:	-30°C to+80°C
Storage temperature range:	-40°C to+85°C

Our Factory:

Company Introduction

Dongguan City Taotao Electronics Co., Ltd, was established in May 2014 and is now located at Weichang Road, Chashan Town, Dongguan City. It has 14,000 square meters of standard factory buildings and dormitories, which has a beautiful environment and convenient transportation. We are a national high-tech enterprise which is professional in designing, manufacturing and selling encoders, potentiometers, switches, sensors, and encoder smart modules. The components are extensively utilized for white household electrical appliances, small home appliances, smart home appliances, car audio, bluetooth audio, multimedia audio, instrumentation, medical equipment, electronic cigarettes, computer peripheral communication equipment, aviation model aircraft and other fields.

Taotao has engaged excellent technical R & D personnel in the industry and management personnel with abundant experiences since establishment. They have been developing new products and conducting improvement and upgrading to meet clients' requirements. For guaranteeing the products quality, they continuously enhance the percentage of self-production for the key parts, like 100% self-producing for plastic parts and lathing shafts, and invest in developing automatic producing machines and testing instruments.

300⁺
employees

14000^{m²}
factory building

500⁺
Cooperative clients



Patents and certificates

工厂展示 FACTORY DISPLAY



MEASURING ROOM
测量室



ENVIRONMENTAL LABORATORY
环境实验室



RECEPTION
前台



GENERAL OFFICE
综合办公室



INJECTION MOLDING WORKSHOP
注塑车间



ASSEMBLY WORKSHOP
组装车间



AUTOMATIC INSPECTION WORKSHOP
自动检测车间



AUTOMATIC WORKSHOP
自动化车间

我们的实力 OUR STRENGTH



五金冲压
METAL STAMPING

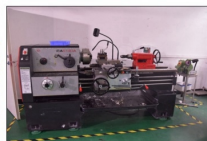

模具车床
MOLD LATHE



寿命实验室
LIFE LABORATORY



轴芯车床
LATHE AXIS CORE



全自动成品组装机
FULLY AUTOMATIC FINISHED PRODUCT
ASSEMBLY MACHINE



立式注塑机
VERTICAL INJECTION MOLDING MACHINE

Laboratory testing equipment 环境一览 • 实验室检测设备



Fisher X-ray Coating
Thickness Gauge
菲希尔 X射线镀层测厚仪

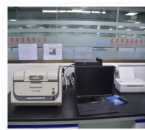

TIANRU ROHS TESTER
天瑞ROHS检测仪



TWO-DIMENSIONAL
二次元



LIFE TESTER
寿命测试仪



PROJECTOR
投影仪



HARDNESS TESTER
硬度测试仪



SWITCH LOAD TESTER
开关负载测试仪



CONSTANT TEMPERATURE
AND HUMIDITY MACHINE
恒温恒湿机



SALT SPRAY TESTER
盐雾测试仪



THERMAL SHOCK
冷热冲击

Application:



FQA:

1. What are the advantages of your factory?

Our factory has mold manufacturing workshop, plastic injection molding workshop and lathe center. 80% of the raw materials are supplied by ourselves to ensure that the quality and delivery speed are higher than those of our peers.

2. Do you support customization?

Yes, customization is supported, we need you to provide drawings, usage and requirements.

3. What is your shipping port and the term of payment ?

Ex-work or FOB Shenzhen.

30% paid in advance, 70% balance before shipment by T/T. (First transaction requires 100% payment in advance.)

4. How long is your lead time?

It will take 3 workdays for samples, 7-15 workdays for mass production.

5. Can I get samples from you?

Small amount of samples can be provided for free, but customers need to pay for air freight themselves.

6. What's your MOQ ?

Our MOQ is 2K. If it is a small batch order, the price needs to be increased appropriately.



Dongguan Taotao Electronics Co., Ltd.



+86 19107690150



zabie@taowaves.com



ttencoder.com

No.8 Weichang Road, Chashan Town, Dongguan City, Guangdong Province, China